

1. RCC PIPE 100 mm (4 ") dia 2 metres long

RCC 1:2:4 BY VOLUME

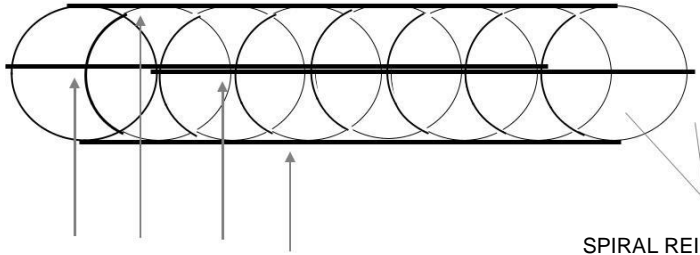
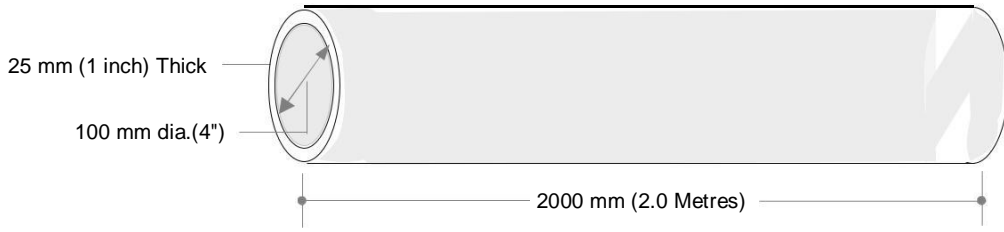

4 Nos. of 5 mm DIA. LONGITUDINAL M.S. BARS MUTUALLY SEPERATED BY 90 °

SPIRAL REINFORCEMENT THROUGHOUT THE LENGTH OF THE PIPE BY USING 18 SEGMENTS 3mm DIA. HARD DRAWN STEEL WIRE

REINFORCEMENT WITH HARD DRAWN STEEL WIRE OF 3mm DIA. OF 0.19 Kg. PER COLLAR

2. RCC COLLAR

SUITABLE FOR RCC 100 mm (4 ") Dia. PIPE **RCC 1:2:4 BY VOLUME**

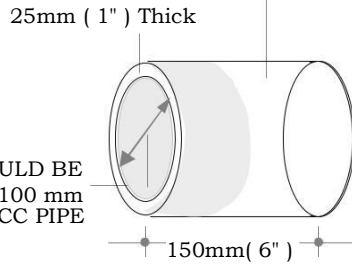

3. RCC SPLIT PIPE

100mm DIA. (4" DIA.) 1 Metre LONG

RCC 1:2:4 BY VOLUME

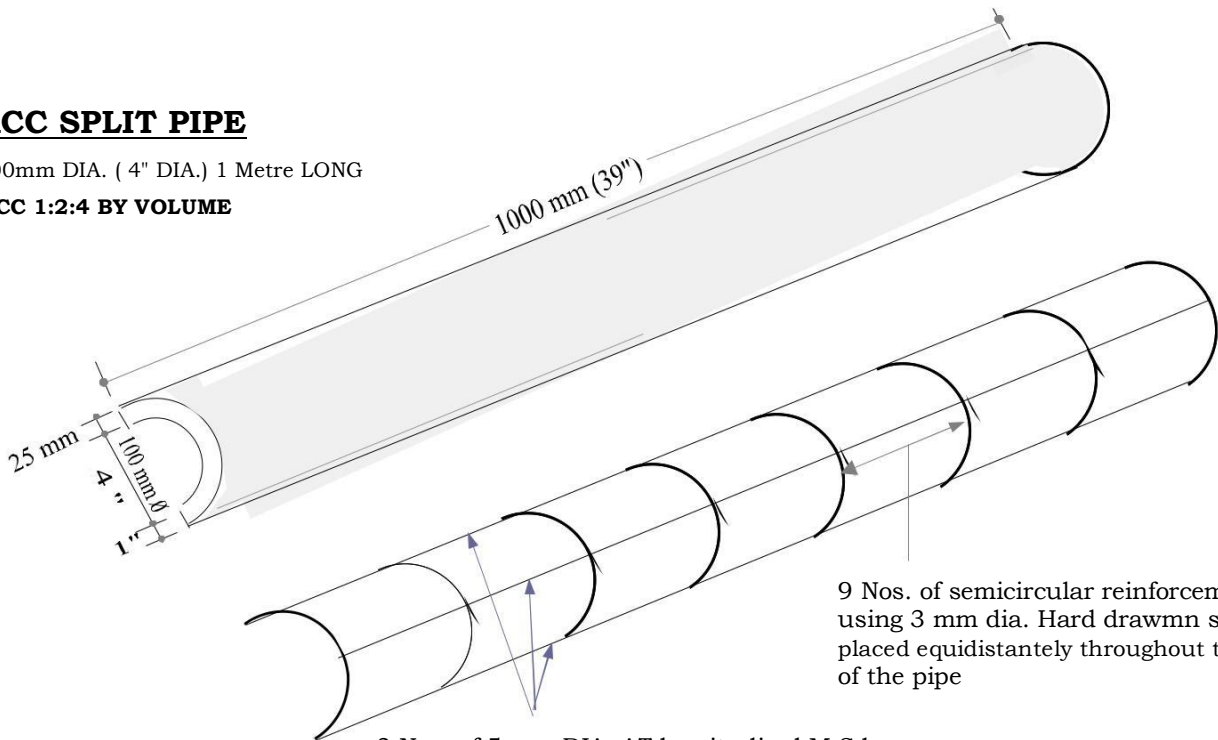

3 Nos. of 5 mm DIA. AT longitudinal M S bars mutually seperated by 90 °

Bharat Sanchar Nigam Limited
(Chennai Telephones)

SIGNATURE & SEAL OF THE TENDERER

R C C RING STRUCTURE

RING STRUCTURE

SIZE: 900 mm INNER Dia.
300 mm HEIGHT
50 mm THICKNESS

CONCRETE MIX 1 :2 :4

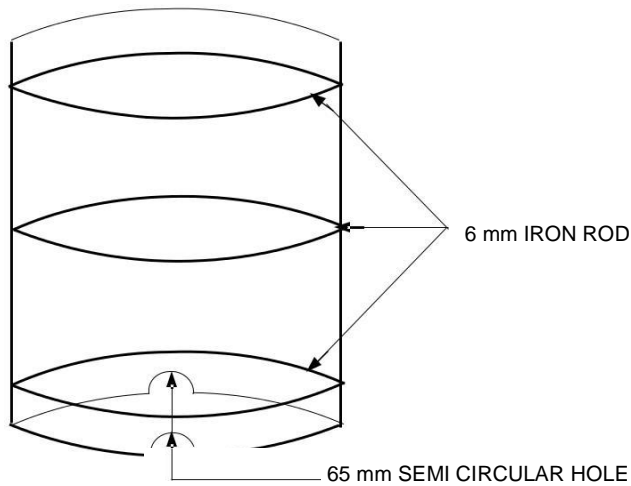

TOP LID (SPLIT) STRUCTURE

SIZE: 1000 mm OUTER Dia.
50 mm THICKNESS

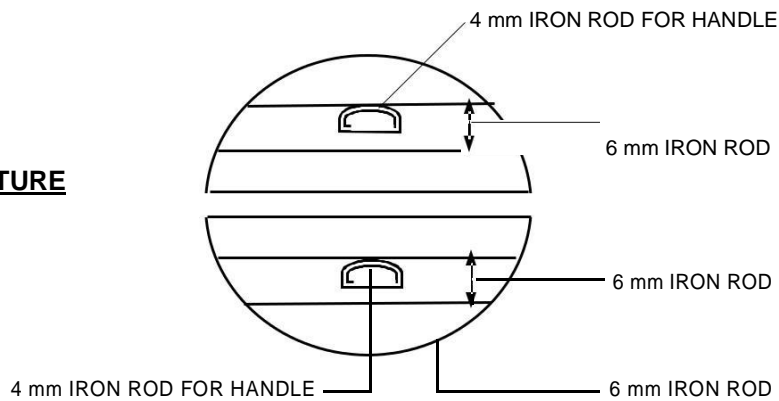

BOTTOM SUPPORT STRUCTURE
(CIRCULAR)

SIZE: 1000 mm OUTER Dia.
50 mm THICKNESS

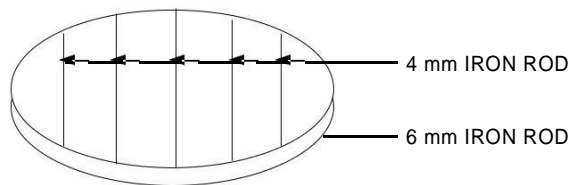

DIAGRAM SHOWING R .C .C RING WITH TOP AND BOTTOM LIDS

Not to Scale

All the dimensions are in mm

Bharat Sanchar Nigam Limited
(Chennai Telephones)
TXI-II ANNA ROAD EXCHANGE
8th FLOOR, CHENNAI-600 002.

D,man.

SDE/ TXI

DE/ TXI- II

R . C . C DETAILS OF O F C ROUTE / JOINT INDICATOR

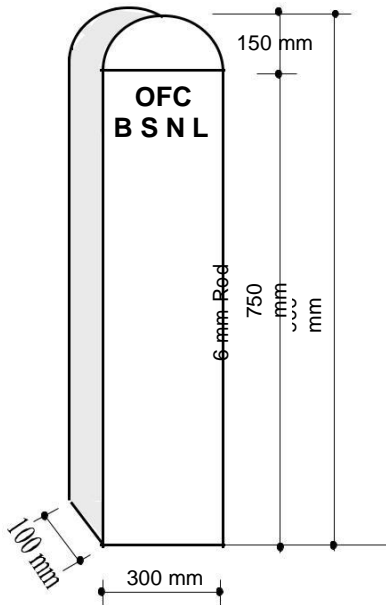

CONCRETE MIX 1 : 2 : 4

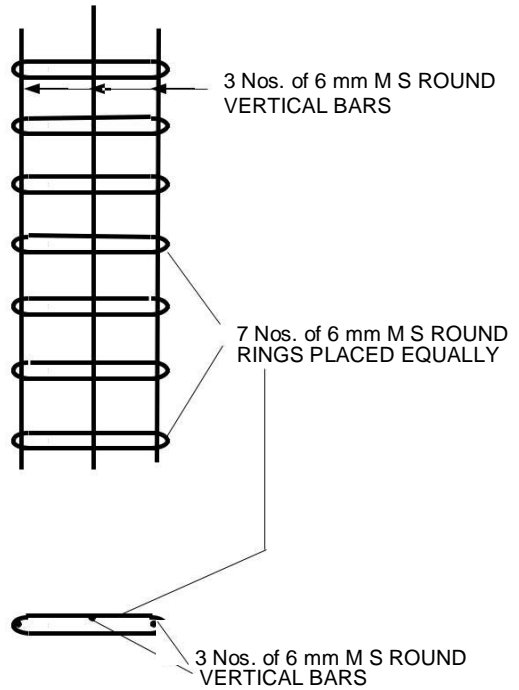

Not to Scale All the dimensions are in mm

Bharat Sanchar Nigam Limited
(Chennai Telephones)
TXI-II ANNA ROAD EXCHANGE
8th FLOOR, CHENNAI-600 002.

	D,man.
	SDE/ TXI
	DE/ TXI- II

**SECTION - XXIX
Annexure - D**

REINFORCEMENT CEMENT CONCRETE DETAILS

CONCRETE MIX 1 :2 :4

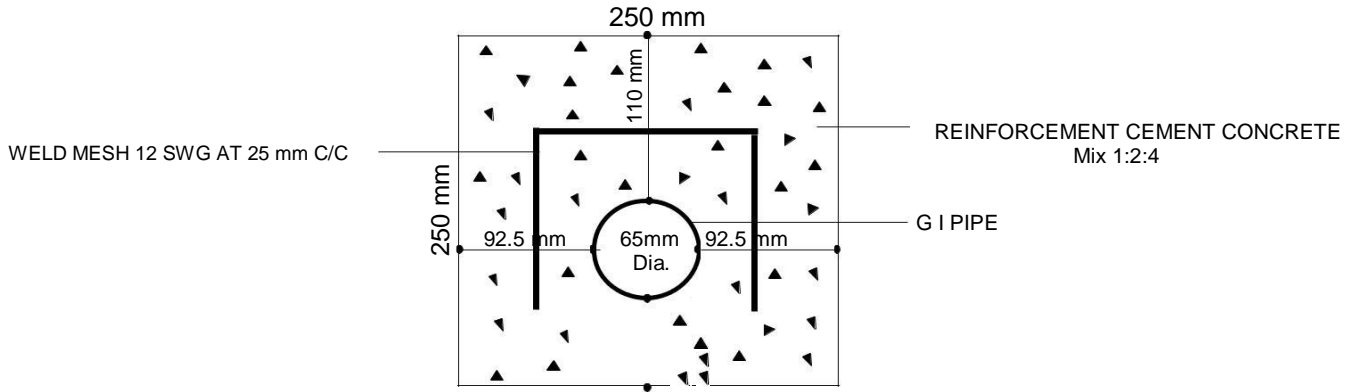

Not to Scale All the dimensions are in mm

Bharat Sanchar Nigam Limited (Chennai Telephones) TXI-II ANNA ROAD EXCHANGE 8th FLOOR, CHENNAI-600 002.	D,man.
	SDE/ TXI
	DE/ TXI- II

CABLE ROUTE OFFSET DIAGRAM

LEGEND :

- PMH - Pulling man hole
- RCC Pipe
- O F Cable
- Depth of Trench 1.65 m

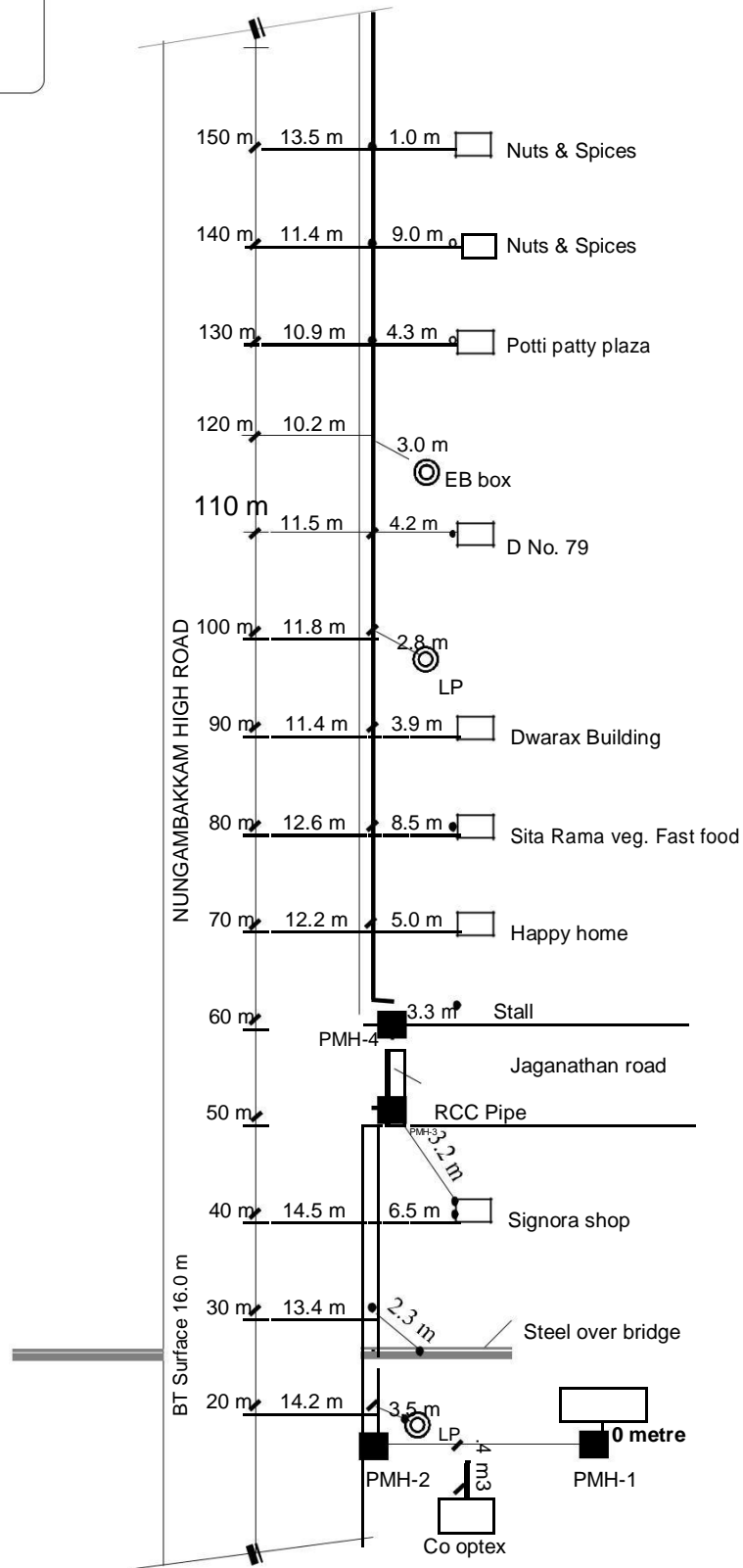

CABLE ROUTE OFFSET DIAGRAM

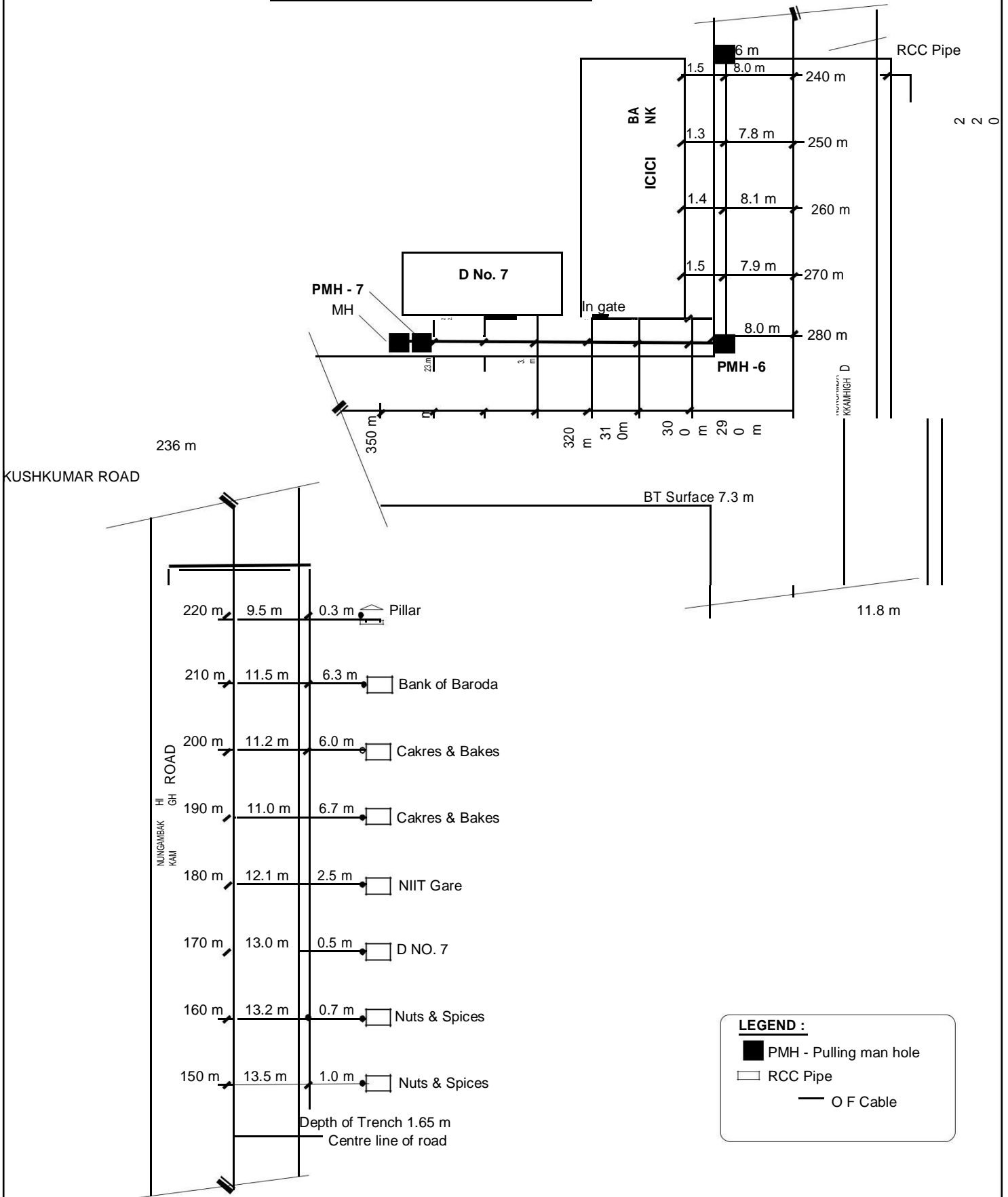

LEGEND :

- PMH - Pulling man hole
- RCC Pipe
- O F Cable

DE / TXM / P3- Page - 6	O F CABLE LAID FROM HDFC TO EXISTING MAN - HOLE AT KUSH KUMAR ROAD (Door No. 7)
O F CABLE LAID - 1 Number	
Not to Scale All the dimensions are in mm	

- b -
PULLING MAN HOLE OFFSET DIAGRAM

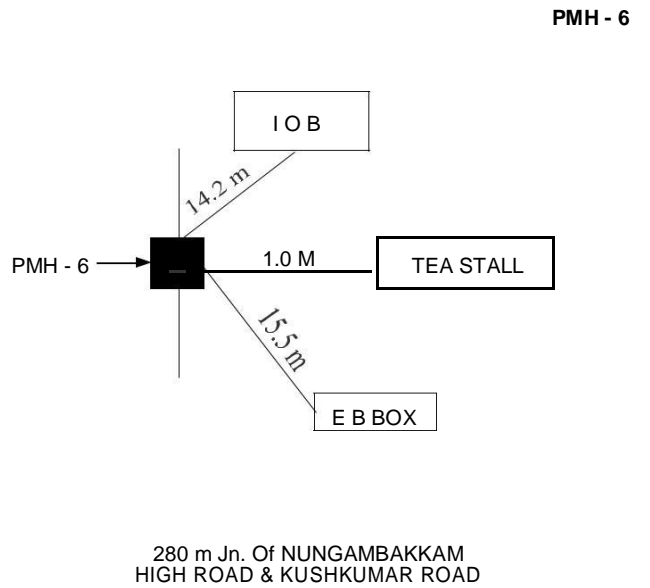
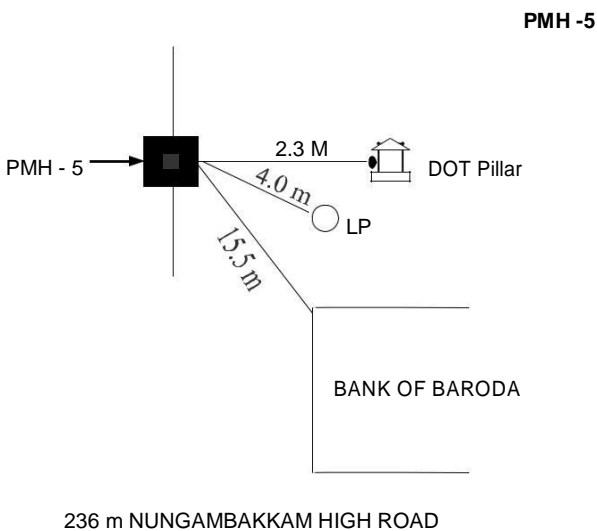
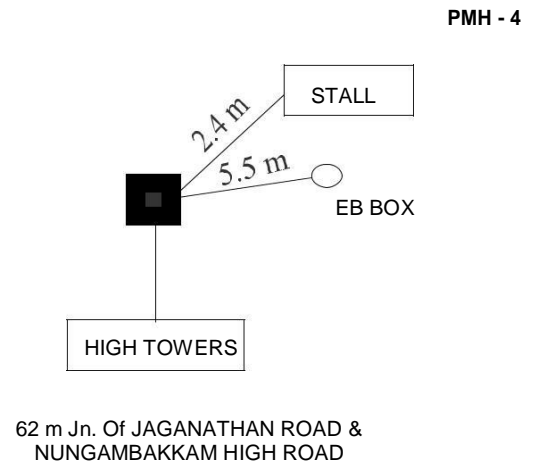
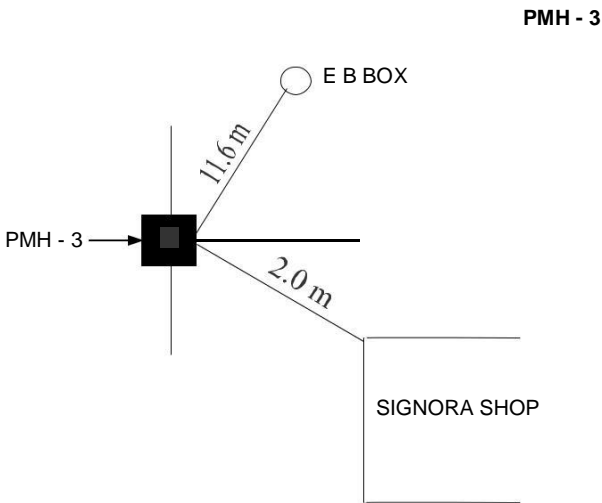
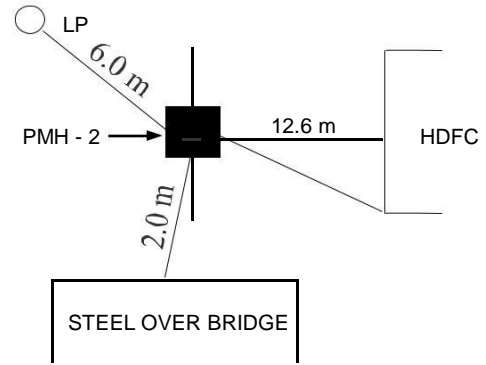
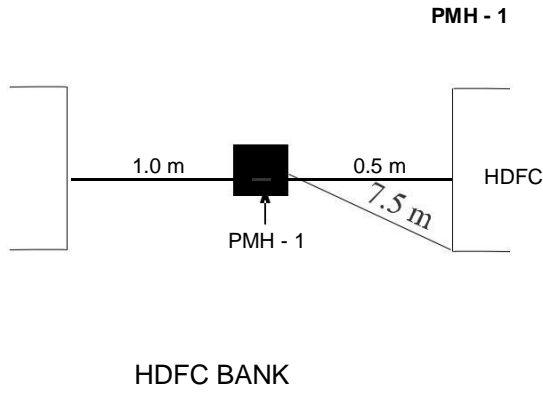

Bharat Sanchar Nigam Limited
(Chennai Telephones)
TXI-II ANNA ROAD EXCHANGE
8th FLOOR, CHENNAI-600 002.

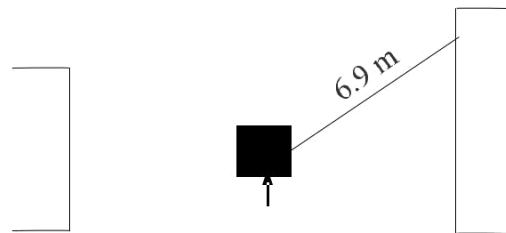

PULLING MAN HOLE OFFSET DIAGRAM

Sheet - 4

P
M
H
-
7

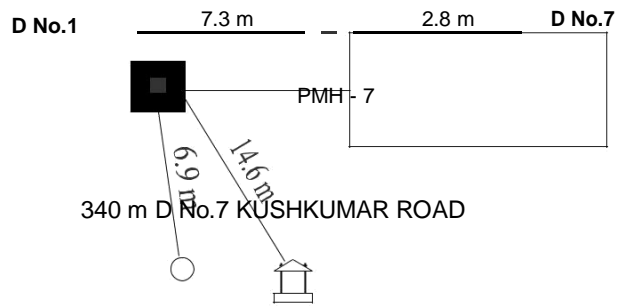

JOINT MAN HOLE OFFSET DIAGRAM

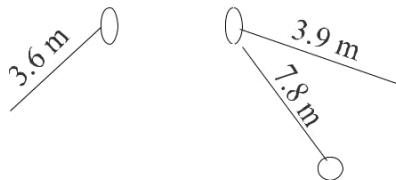

DOT PILLAR

J
M
H
-
1

R.C.C.PIPE OFFSET DIAGRAM

RCC - 1

RCC - 2



16 m RCC Pipe at NUNGAMBAKKAM HIGH ROAD

SHEET 4 of 4

Not to Scale All the dimensions are in mm

Bharat Sanchar Nigam Limited
(Chennai Telephones)
TXI-II ANNA ROAD EXCHANGE
8th FLOOR, CHENNAI-600 002